

Concealed ceiling unit with medium ESP

Slimmest yet most powerful medium static pressure unit on the market

- > Combination with Sky Air Alpha-series ensures best in class quality, highest efficiency and performance
- > Slimmest unit in class, only 245mm (300mm built-in height) and therefore narrow ceiling voids are no longer a challenge
- > Low operation sound level down to 25dBA
- > Medium external static pressure up to 150Pa facilitates using flexible ducts of varying lengths
- > Possibility to change ESP via wired remote control allows optimisation of the supply air volume
- > Discretely concealed in the ceiling: only the suction and discharge grilles are visible
- > Multi zoning kit allows multiple individually-controlled climate zones to be served by one indoor unit
- > Optional fresh air intake
- > Flexible installation: air suction direction can be altered from rear to bottom suction and choice between free use or connection to optional suction grilles
- > Standard built-in drain pump with 625mm lift increases flexibility and installation speed
- > **NEW** RZAG-A mini Sky Air Alpha-series includes technical cooling function
- > **NEW** New single fan Sky Air Alpha-series range!



| Efficiency data | | FBA + RZAG | 35A9 + 35A | 50A9 + 50A | 60A9 + 60A | 71A9 + 71NV1 | 100A + 100NV1 | 125A + 125NV1 | 140A + 140NV1 | 71A9 + 71NY1 | 100A + 100NY1 | 125A + 125NY1 | 140A + 140NY1 | | |
|---------------------------------|-------------------------------|--------------------|--|------------|-------------------------|----------------|---|----------------|----------------|----------------|----------------|----------------|----------------|----------------|----|
| Cooling capacity | Nom. | kW | 3.5 | 5.0 | 6.0 | 6.80 | 9.50 | 12.1 | 13.4 | 6.80 | 9.50 | 12.1 | 13.4 | | |
| Heating capacity | Nom. | kW | 4.0 | 6.0 | 7.0 | 7.50 | 10.8 | 13.5 | 15.5 | 7.50 | 10.8 | 13.5 | 15.5 | | |
| Space cooling | Energy efficiency class | | A++ | A+ | A++ | A++ | | - | | A++ | | - | | | |
| | Capacity | Pdesign | kW | 3.5 | 5.0 | 6.0 | 6.80 | 9.50 | 12.1 | 13.4 | 6.80 | 9.50 | 12.1 | 13.4 | |
| | SEER | | | 6.12 | 6.3 | 6.15 | 6.22 | 6.47 | 6.19 | 6.42 | 6.22 | 6.47 | 6.19 | 6.42 | |
| | ηs,c | | % | - | - | - | - | 245 | 254 | - | - | 245 | 254 | - | |
| | Annual energy consumption | kWh/a | 200 | 278 | 341 | 382 | 514 | 1,173 | 1,252 | 382 | 514 | 1,173 | 1,252 | | |
| Space heating (Average climate) | Energy efficiency class | | A+ | | A+ | | - | | A+ | | - | | - | | |
| | Capacity | Pdesign | kW | 4.2 | 4.3 | 4.5 | 4.70 | 7.80 | 9.52 | | 4.70 | 7.80 | 9.52 | | |
| | SCOP/A | | | 4.10 | 4.10 | 4.10 | 4.20 | 4.36 | 4.12 | 4.11 | 4.20 | 4.36 | 4.12 | 4.11 | |
| | ηs,h | | % | - | - | - | - | 162 | 161 | - | - | 162 | 161 | - | |
| | Annual energy consumption | kWh/a | 1,434 | 1,469 | 1,537 | 1,566 | 2,505 | 3,235 | 3,243 | 1,566 | 2,505 | 3,235 | 3,243 | | |
| Indoor unit | | FBA | 35A9 | 50A9 | 60A9 | 71A9 | 100A | 125A | 140A | 71A9 | 100A | 125A | 140A | | |
| Dimensions | Unit | HeightxWidthxDepth | 245x700x800 | | 245x1,000x800 | 245x1,000x800 | 245x1,400x800 | | 245x1,000x800 | | 245x1,400x800 | | 140A | | |
| Weight | Unit | kg | 28.0 | | 35.0 | 35.0 | 46.0 | | 35.0 | | 46.0 | | | | |
| Air filter | Type | | Resin net | | | | Resin net | | | | | | | | |
| Fan | Air flow rate | Cooling | Low/Medium/High | m³/min | | 10.5/12.5/15.0 | 12.5/15.0/18.0 | 12.5/15.0/18.0 | 23.0/26.0/29.0 | 23.5/29.0/34.0 | 12.5/15.0/18.0 | 23.0/26.0/29.0 | 23.5/29.0/34.0 | 23.5/29.0/34.0 | |
| | | Heating | Low/Medium/High | m³/min | | 10.5/12.5/15.0 | 12.5/15.0/18.0 | 12.5/15.0/18.0 | 23.0/26.0/29.0 | 23.5/29.0/34.0 | 12.5/15.0/18.0 | 23.0/26.0/29.0 | 23.5/29.0/34.0 | 23.5/29.0/34.0 | |
| | External static pressure | Nom./High | Pa | | 30/150 | | 30/150 | 40/150 | 50/150 | 30/150 | 40/150 | 50/150 | 50/150 | | |
| Sound power level | Cooling | | dBA | | 60 | 56 | 56 | 58 | 62 | 56 | 58 | 62 | 62 | | |
| Sound pressure level | Cooling | Low/High | dBA | | 29.0/35.0 | 25.0/30.0 | 25.0/30.0 | 30.0/34.0 | 32.0/37.0 | 25.0/30.0 | 30.0/34.0 | 32.0/37.0 | 32.0/37.0 | | |
| | Heating | Low/High | dBA | | 29.0/37.0 | 25.0/31.0 | 25.0/31.0 | 30.0/36.0 | 32.0/38.0 | 25.0/31.0 | 30.0/36.0 | 32.0/38.0 | 32.0/38.0 | | |
| Control systems | Infrared remote control | | BRC4C65 / BRC4C66 | | | | BRC4C65 / BRC4C66 | | | | | | | | |
| | Wired remote control | | BRC1H519W/S/K / BRC1E53A/B/C / BRC1D52 | | | | BRC1H519W/S/K7 / BRC1E53A/B/C / BRC1D52 | | | | | | | | |
| Power supply | Phase/Frequency/Voltage | Hz/V | 1~/50/60/220-240/220 | | | | 1~/50/60/220-240/220 | | | | | | | | |
| Outdoor unit | | RZAG | 35A | 50A | 60A | 71NV1 | 100NV1 | 125NV1 | 140NV1 | 71NY1 | 100NY1 | 125NY1 | 140NY1 | | |
| Dimensions | Unit | HeightxWidthxDepth | 734x870x373 | | | | 870x1,100x460 | | | | | | | | |
| Weight | Unit | kg | 52 | | 70 | 92 | 70 | | 92 | | 70 | | 92 | | |
| Sound power level | Cooling | | dBA | | 62 | 63 | 64 | 64 | 66 | 69 | 70 | 65 | 66 | 69 | 70 |
| | Heating | | dBA | | 62 | 63 | 64 | - | 69 | 70 | - | 69 | 70 | | |
| Sound pressure level | Cooling | Nom. | dBA | | 48 | 49 | 50 | 46 | 47 | 50 | 51 | 46 | 47 | 50 | 51 |
| | Heating | Nom. | dBA | | 48 | 49 | 50 | 49 | 51 | 52 | 49 | 51 | 52 | | |
| Operation range | Cooling | Ambient | Min.~Max. | °CDB | | -20 / +52 | | -20~52 | | -20~52 | | -20~52 | | | |
| | Heating | Ambient | Min.~Max. | °CWB | | -20 / +24 | | -20~18.0 | | -20~18.0 | | -20~18.0 | | | |
| Refrigerant | Type/GWP | | R32 / 675 | | | | R-32/675 | | | | | | | | |
| | Charge | kg/CO2Eq | 1.55/1.05 | | 2.95/1.99 | 3.75/2.53 | 2.95/1.99 | 3.75/2.53 | 2.95/1.99 | | 3.75/2.53 | | | | |
| Piping connections | Liquid/Gas | OD | mm | | 6.4 / 9.52 | 6.4/12.7 | | 9.52/15.9 | | 9.52/15.9 | | 9.52/15.9 | | | |
| | Piping length | OU - IU | Max. | m | | 50 | | 55 | 85 | 55 | | 85 | | | |
| | | System | Equivalent | m | | 50 | | 75 | 100 | 75 | | 100 | | | |
| | | Chargeless | | m | | 30 | | 40 | | 40 | | 40 | | | |
| | Additional refrigerant charge | | kg/m | | See installation manual | | | | | | | | | | |
| | Level difference | IU - OU | Max. | m | | 30 | | 30.0 | | 30.0 | | 30.0 | | | |
| Power supply | Phase/Frequency/Voltage | Hz/V | Single / 50 / 230 | | | | 1~/50/220-240 | | 3~/50/380-415 | | 3~/50/380-415 | | | | |
| Current - 50Hz | Maximum fuse amps (MFA) | A | 16 | 16 | 20 | 20 | 32 | 16 | | 16 | | | | | |

(1) MFA is used to select the circuit breaker and the ground fault circuit interrupter(earth leakage circuit breaker). For more detailed information on each combination, please refer to the electrical data drawing.

*Note: blue cells contain preliminary data

Concealed ceiling unit with medium ESP

Slimmest yet most powerful medium static pressure unit on the market

- › Combination with Sky Air Alpha-series ensures best in class quality, highest efficiency and performance
- › Slimmest unit in class, only 245mm (300mm built-in height) and therefore narrow ceiling voids are no longer a challenge
- › Low operation sound level down to 25dBA
- › Medium external static pressure up to 150Pa facilitates using flexible ducts of varying lengths
- › Possibility to change ESP via wired remote control allows optimisation of the supply air volume
- › Discretely concealed in the ceiling: only the suction and discharge grilles are visible
- › Multi zoning kit allows multiple individually-controlled climate zones to be served by one indoor unit
- › Optional fresh air intake
- › Flexible installation: air suction direction can be altered from rear to bottom suction and choice between free use or connection to optional suction grilles
- › Standard built-in drain pump with 625mm lift increases flexibility and installation speed



| Efficiency data | | FBA + RZAG | 71A9 + 71MV1 | 100A + 100MV1 | 125A + 125MV1 | 140A + 140MV1 | 71A9 + 71MY1 | 100A + 100MY1 | 125A + 125MY1 | 140A + 140MY1 | | |
|------------------------------------|---------------------------|-------------------------------|-----------------|---------------|---|----------------|----------------|---------------|----------------|----------------|----------------|----|
| Cooling capacity | Nom. | kW | 6.80 | 9.50 | 12.1 | 13.4 | 6.80 | 9.50 | 12.1 | 13.4 | | |
| Heating capacity | Nom. | kW | 7.50 | 10.8 | 13.5 | 15.5 | 7.50 | 10.8 | 13.5 | 15.5 | | |
| Space cooling | Energy efficiency class | | A++ | | - | | A++ | | - | | | |
| | Capacity | Pdesign | kW | 6.80 | 9.50 | 12.1 | 13.4 | 6.80 | 9.50 | 12.1 | 13.4 | |
| | SEER | | | 6.22 | 6.47 | 6.19 | 6.42 | 6.22 | 6.47 | 6.19 | 6.42 | |
| | ηs,c | | % | - | - | 245 | 254 | - | - | 245 | 254 | |
| | Annual energy consumption | | kWh/a | 382 | 514 | 1,173 | 1,252 | 382 | 514 | 1,173 | 1,252 | |
| Space heating (Average climate) | Energy efficiency class | | A+ | | - | | A+ | | - | | | |
| | Capacity | Pdesign | kW | 4.70 | 7.80 | 9.52 | | 4.70 | 7.80 | 9.52 | | |
| | SCOP/A | | | 4.20 | 4.36 | 4.12 | 4.11 | 4.20 | 4.36 | 4.12 | 4.11 | |
| | ηs,h | | % | - | - | 162 | 161 | - | - | 162 | 161 | |
| | Annual energy consumption | | kWh/a | 1,566 | 2,505 | 3,235 | 3,243 | 1,566 | 2,505 | 3,235 | 3,243 | |
| Indoor unit | | FBA | 71A9 | 100A | 125A | 140A | 71A9 | 100A | 125A | 140A | | |
| Dimensions | Unit | HeightxWidthxDepth | mm | 245x1,000x800 | | | 245x1,000x800 | | | 245x1,400x800 | | |
| Weight | Unit | | kg | 35.0 | | | 35.0 | | | 46.0 | | |
| Air filter | Type | | | Resin net | | | | | | | | |
| Fan | Air flow rate | Cooling | Low/Medium/High | m³/min | 12.5/15.0/18.0 | 23.0/26.0/29.0 | 23.5/29.0/34.0 | | 12.5/15.0/18.0 | 23.0/26.0/29.0 | 23.5/29.0/34.0 | |
| | | Heating | Low/Medium/High | m³/min | 12.5/15.0/18.0 | 23.0/26.0/29.0 | 23.5/29.0/34.0 | | 12.5/15.0/18.0 | 23.0/26.0/29.0 | 23.5/29.0/34.0 | |
| | External static pressure | Nom./High | | Pa | 30/150 | 40/150 | 50/150 | | 30/150 | 40/150 | 50/150 | |
| Sound power level | Cooling | | | dBA | 56 | 58 | 62 | | 56 | 58 | 62 | |
| Sound pressure level | Cooling | Low/High | | dBA | 25.0/30.0 | 30.0/34.0 | 32.0/37.0 | | 25.0/30.0 | 30.0/34.0 | 32.0/37.0 | |
| | Heating | Low/High | | dBA | 25.0/31.0 | 30.0/36.0 | 32.0/38.0 | | 25.0/31.0 | 30.0/36.0 | 32.0/38.0 | |
| Control systems | Infrared remote control | | | | BRC4C65 / BRC4C66 | | | | | | | |
| | Wired remote control | | | | BRC1H519W/S/K7 / BRC1E53A/B/C / BRC1D52 | | | | | | | |
| Power supply | Phase/Frequency/Voltage | | | Hz/V | 1~/50/60/220-240/220 | | | | | | | |
| Outdoor unit | | RZAG | 71MV1 | 100MV1 | 125MV1 | 140MV1 | 71MY1 | 100MY1 | 125MY1 | 140MY1 | | |
| Dimensions | Unit | HeightxWidthxDepth | mm | 990x940x320 | | | 990x940x320 | | | 1,430x940x320 | | |
| Weight | Unit | | kg | 70 | | | 70 | | | 92 | | |
| Sound power level | Cooling | | | dBA | 64 | 66 | 69 | 70 | 65 | 66 | 69 | 70 |
| | Heating | | | dBA | - | - | 69 | 70 | - | - | 69 | 70 |
| Sound pressure level | Cooling | Nom. | | dBA | 46 | 47 | 50 | 51 | 46 | 47 | 50 | 51 |
| | Heating | Nom. | | dBA | 49 | 51 | 52 | | 49 | 51 | 52 | |
| Operation range | Cooling | Ambient | Min.~Max. | °CDB | -20~52 | | | | | | | |
| | Heating | Ambient | Min.~Max. | °CWB | -20~18.0 | | | | | | | |
| Refrigerant | Type/GWP | | | | R-32/675 | | | | | | | |
| Piping connections | Charge | | | kg/TCO2Eq | 2.95/1.99 | | 3.75/2.53 | | 2.95/1.99 | | 3.75/2.53 | |
| | Liquid/Gas | OD | | mm | 9.52/15.9 | | | | | | | |
| Piping length | OU - IU | Max. | | m | 55 | | | 85 | | | 55 | |
| | | System | Equivalent | m | 75 | | | 100 | | | 75 | |
| | Chargeless | | | m | 40 | | | | | | | |
| | | Additional refrigerant charge | | kg/m | See installation manual | | | | | | | |
| Power supply | Level difference | IU - OU | Max. | m | 30.0 | | | | | | | |
| | Phase/Frequency/Voltage | | | Hz/V | 1~/50/220-240 | | | 3~/50/380-415 | | | | |
| Current - 50Hz | Maximum fuse amps (MFA) | | A | 20 | | | 32 | | | 16 | | |

(1) MFA is used to select the circuit breaker and the ground fault circuit interrupter(earth leakage circuit breaker). For more detailed information on each combination, please refer to the electrical data drawing.

Concealed ceiling unit with medium ESP

Slimmest yet most powerful medium static pressure unit on the market

- > Combination with Sky Air Advance-series ensures good value for money for all types of commercial applications
- > Slimmest unit in class, only 245mm (300mm built-in height) and therefore narrow ceiling voids are no longer a challenge
- > Low operation sound level down to 25dBA
- > Medium external static pressure up to 150Pa facilitates using flexible ducts of varying lengths
- > Possibility to change ESP via wired remote control allows optimisation of the supply air volume



Optimised supply air volume

Automatically selects the most appropriate fan curve to achieve the units' nominal air flow within ±10%

Why?

After installation the real ducting will frequently differ from the initially calculated air flow resistance → the real air flow may be much lower or higher than nominal, leading to a lack of capacity or uncomfortable air temperature.

Automatic Airflow Adjustment function will adapt the unit's fan speed to any ducting automatically (10 or more fan curves are available on every model), making installation much faster

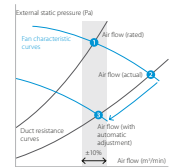

| Efficiency data | | FBA + RZASG | 71A9 + 71MV1 | 100A + 100MV1 | 125A + 125MV1 | 140A + 140MV1 | 100A + 100MY1 | 125A + 125MY1 | 140A + 140MY1 | |
|------------------------------------|-------------------------------|--------------------|-----------------|---|-------------------------|----------------|----------------|----------------|----------------|-------|
| Cooling capacity | Nom. | kW | 6.80 | 9.50 | 12.1 | 13.4 | 9.50 | 12.1 | 13.4 | |
| Heating capacity | Nom. | kW | 7.50 | 10.8 | 13.5 | 15.5 | 10.8 | 13.5 | 15.5 | |
| Space cooling | Energy efficiency class | | A++ | A+ | | | A+ | | | |
| | Capacity | Pdesign | kW | 6.80 | 9.50 | 12.1 | 13.4 | 9.50 | 12.1 | |
| | SEER | | 6.19 | 5.83 | 5.49 | 5.81 | 5.83 | 5.49 | 5.81 | |
| | ηs,c | | % | - | - | 217 | 229 | - | 217 | 229 |
| | Annual energy consumption | | kWh/a | 385 | 570 | 1,322 | 1,384 | 570 | 1,322 | 1,384 |
| Space heating (Average climate) | Energy efficiency class | | A+ | A | | | A | | | |
| | Capacity | Pdesign | kW | 4.50 | 6.00 | 7.80 | 6.00 | 7.80 | | |
| | SCOP/A | | 4.01 | 3.85 | 3.63 | 3.85 | 3.63 | 3.85 | | |
| | ηs,h | | % | - | - | 142 | 151 | - | 142 | 151 |
| | Annual energy consumption | | kWh/a | 1,571 | 2,182 | 2,314 | 2,836 | 2,182 | 2,314 | 2,836 |
| Indoor unit | | FBA | 71A9 | 100A | 125A | 140A | 100A | 125A | 140A | |
| Dimensions | Unit | HeightxWidthxDepth | mm | 245x1,000x800 | 245x1,400x800 | | | | | |
| Weight | Unit | | kg | 35.0 | 46.0 | | | | | |
| Air filter | Type | | | Resin net | | | | | | |
| Fan | Air flow rate | Cooling | Low/Medium/High | m ³ /min | 12.5/15.0/18.0 | 23.0/26.0/29.0 | 23.5/29.0/34.0 | 23.0/26.0/29.0 | 23.5/29.0/34.0 | |
| | | Heating | Low/Medium/High | m ³ /min | 12.5/15.0/18.0 | 23.0/26.0/29.0 | 23.5/29.0/34.0 | 23.0/26.0/29.0 | 23.5/29.0/34.0 | |
| | External static pressure | Nom./High | | Pa | 30/150 | 40/150 | 50/150 | 40/150 | 50/150 | |
| Sound power level | Cooling | | | dBA | 56 | 58 | 62 | 58 | 62 | |
| Sound pressure level | Cooling | Low/High | | dBA | 25.0/30.0 | 30.0/34.0 | 32.0/37.0 | 30.0/34.0 | 32.0/37.0 | |
| | Heating | Low/High | | dBA | 25.0/31.0 | 30.0/36.0 | 32.0/38.0 | 30.0/36.0 | 32.0/38.0 | |
| Control systems | Infrared remote control | | | BRC4C65 / BRC4C66 | | | | | | |
| | Wired remote control | | | BRC1H519W/S/K7 / BRC1E53A/B/C / BRC1D52 | | | | | | |
| Power supply | Phase/Frequency/Voltage | | | Hz/V | 1~/50/60/220-240/220 | | | | | |
| Outdoor unit | | RZASG | 71MV1 | 100MV1 | 125MV1 | 140MV1 | 100MY1 | 125MY1 | 140MY1 | |
| Dimensions | Unit | HeightxWidthxDepth | mm | 770x900x320 | 990x940x320 | | | | | |
| Weight | Unit | | kg | 60 | 70 | 78 | 70 | 71 | 77 | |
| Sound power level | Cooling | | | dBA | 65 | 70 | 71 | 70 | 73 | |
| | Heating | | | dBA | - | - | 71 | - | 73 | |
| Sound pressure level | Cooling | Nom. | | dBA | 46 | 53 | 54 | 53 | 54 | |
| | Heating | Nom. | | dBA | 47 | - | 57 | - | 57 | |
| Operation range | Cooling | Ambient | Min.-Max. | °CDB | -15~-46 | | | | | |
| | Heating | Ambient | Min.-Max. | °CWB | -15~-15.5 | | | | | |
| Refrigerant | Type/GWP | | | | R-32/675 | | | | | |
| | Charge | | | kg/CO ₂ Eq | 2.45/1.65 | 2.60/1.76 | 2.90/1.96 | 2.60/1.76 | 2.90/1.96 | |
| Piping connections | Liquid/Gas | OD | | mm | 9.52/15.9 | | | | | |
| | Piping length | OU - IU | Max. | m | 50 | | | | | |
| | | System | Equivalent | | m | 70 | | | | |
| | | Chargeless | | | m | 30 | | | | |
| | Additional refrigerant charge | | | kg/m | See installation manual | | | | | |
| Level difference | IU - OU | Max. | | m | 30.0 | | | | | |
| Power supply | Phase/Frequency/Voltage | | | Hz/V | 1~/50/220-240 | | | | 3~/50/380-415 | |
| Current - 50Hz | Maximum fuse amps (MFA) | | A | 20 | 25 | 32 | | 16 | | |

(1) MFA is used to select the circuit breaker and the ground fault circuit interrupter (earth leakage circuit breaker). For more detailed information on each combination, please refer to the electrical data drawing.

Concealed ceiling unit with medium ESP

Slimmest yet most powerful medium static pressure unit on the market

- > Ideal solution for small businesses and shops
- > Slimmest unit in class, only 245mm (300mm built-in height) and therefore narrow ceiling voids are no longer a challenge
- > Low operation sound level down to 25dBA
- > Medium external static pressure up to 150Pa facilitates using flexible ducts of varying lengths
- > Possibility to change ESP via wired remote control allows optimisation of the supply air volume
- > Discretely concealed in the ceiling: only the suction and discharge grilles are visible
- > Multi zoning kit allows multiple individually-controlled climate zones to be served by one indoor unit
- > Optional fresh air intake
- > Flexible installation: air suction direction can be altered from rear to bottom suction and choice between free use or connection to optional suction grilles

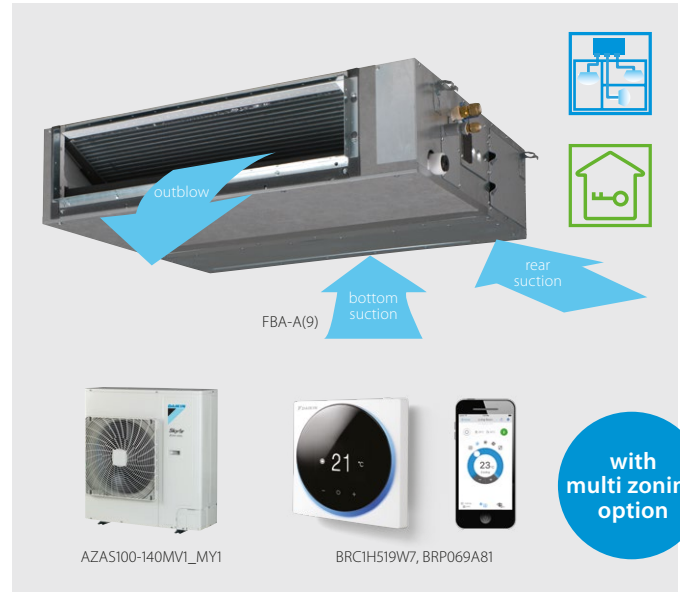

> Standard built-in drain pump with 625mm lift increases flexibility and installation speed

Optimised supply air volume

Automatically selects the most appropriate fan curve to achieve the units' nominal air flow within ±10%

Why?

After installation the real ducting will frequently differ from the initially calculated air flow resistance → the real air flow may be much lower or higher than nominal, leading to a lack of capacity or uncomfortable air temperature. Automatic Airflow Adjustment function will adapt the unit's fan speed to any ducting automatically. (10 or more fan curves are available on every model), making installation much faster

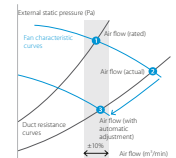

NEW

| Efficiency data | | FBA + AZAS | 71A9 + ARXM71N9 | 100A + 100MV1 | 125A + 125MV1 | 140A + 140MV1 | 100A + 100MY1 | 125A + 125MY1 | 140A + 140MY1 | | |
|---------------------------------|-------------------------------|--------------------|-----------------|---------------|---|-------------------------|---|----------------|----------------|-------|--|
| Cooling capacity | Nom. | kW | 6.80 | 9.50 | 12.1 | 13.4 | 9.50 | 12.1 | 13.4 | | |
| Heating capacity | Nom. | kW | 7.50 | 10.8 | 13.5 | 15.5 | 10.8 | 13.5 | 15.5 | | |
| Space cooling | Energy efficiency class | | A | A | - | - | A | - | - | | |
| | Capacity | Pdesign | kW | 6.80 | 9.50 | 12.1 | 13.0 | 9.50 | 12.1 | | |
| | SEER | | 5.57 | 5.25 | 4.85 | 5.50 | 5.25 | 4.85 | 5.50 | | |
| | ηs,c | | % | - | - | 191 | 217 | - | 191 | 217 | |
| | Annual energy consumption | | kWh/a | - | 633 | 1,497 | 1,418 | 633 | 1,497 | 1,418 | |
| Space heating (Average climate) | Energy efficiency class | | A | A | - | - | A | - | - | | |
| | Capacity | Pdesign | kW | 4.50 | 6.00 | 7.80 | 6.00 | 7.80 | 6.00 | | |
| | SCOP/A | | 3.81 | 3.81 | 3.55 | 3.85 | 3.81 | 3.55 | 3.85 | | |
| | ηs,h | | % | - | - | 139 | 151 | - | 139 | 151 | |
| | Annual energy consumption | | kWh/a | - | 2,205 | 2,366 | 2,836 | 2,205 | 2,366 | 2,836 | |
| Indoor unit | | FBA | 71A9 | 100A | 125A | 140A | 100A | 125A | 140A | | |
| Dimensions | Unit | HeightxWidthxDepth | mm | 245x1,000x800 | | | | | | | |
| Weight | Unit | | kg | 35.0 | | | | | | | |
| Air filter | Type | | | Resin net | | | | | | | |
| Fan | Air flow rate | Cooling | Low/Medium/High | m³/min | 12.5/15.0/18.0 | 23.0/26.0/29.0 | 23.5/29.0/34.0 | 23.0/26.0/29.0 | 23.5/29.0/34.0 | | |
| | | Heating | Low/Medium/High | m³/min | 12.5/15.0/18.0 | 23.0/26.0/29.0 | 23.5/29.0/34.0 | 23.0/26.0/29.0 | 23.5/29.0/34.0 | | |
| External static pressure | Nom./High | | | Pa | 30/150 | 40/150 | 50/150 | 40/150 | 50/150 | | |
| | | | | | | | | | | | |
| Sound power level | Cooling | | | dBA | 56 | 58 | 62 | 58 | 62 | | |
| Sound pressure level | Cooling | Low/High | | dBA | 25.0/30.0 | 30.0/34.0 | 32.0/37.0 | 30.0/34.0 | 32.0/37.0 | | |
| | Heating | Low/High | | dBA | 25.0/31.0 | 30.0/36.0 | 32.0/38.0 | 30.0/36.0 | 32.0/38.0 | | |
| Control systems | Infrared remote control | | | | BRC4C65 / BRC4C66 | | BRC4C65 / BRC4C66 | | | | |
| | Wired remote control | | | | BRC1H519W/S/K7 / BRC1E53A/B/C / BRC1D52 | | BRC1H519W/S/K7 / BRC1E53A/B/C / BRC1D52 | | | | |
| Power supply | Phase/Frequency/Voltage | | | Hz/V | 1~/50/60/220-240/220 | | 1~/50/60/220-240/220 | | | | |
| Outdoor unit | | AZAS/AZAS | 71MV1 | 100MV1 | 125MV1 | 140MV1 | 100MY1 | 125MY1 | 140MY1 | | |
| Dimensions | Unit | HeightxWidthxDepth | mm | 734x870x373 | | | | | | | |
| Weight | Unit | | kg | 50 | | | | | | | |
| Sound power level | Cooling | | | dBA | 65 | 70 | 71 | 73 | 70 | | |
| | Heating | | | dBA | 65 | - | 71 | 73 | - | | |
| Sound pressure level | Cooling | Nom. | | dBA | 52 | 53 | 54 | 53 | 54 | | |
| | Heating | Nom. | | dBA | 52 | | | 57 | | | |
| Operation range | Cooling | Ambient | Min.~Max. | °CDB | -10~46 | | | -5~46 | | | |
| | Heating | Ambient | Min.~Max. | °CWB | -15~18 | | | -15~15.5 | | | |
| Refrigerant | Type/GWP | | | | R-32/675 | | | | | | |
| | Charge | | | kg/CO2Eq | 1.15 / 0.78 | 2.60/1.76 | 2.90/1.96 | 2.60/1.76 | 2.90/1.96 | | |
| Piping connections | Liquid/Gas | OD | | mm | 9.52/15.9 | | | | | | |
| | Piping length | OU - IU | Max. | m | 20 | | | | | | |
| | | System | Equivalent | | m | - | | | | | |
| | | Chargeless | | | m | 10 | | | | | |
| | Additional refrigerant charge | Level difference | IU - OU | Max. | kg/m | See installation manual | | | | | |
| Power supply | Phase/Frequency/Voltage | | | Hz/V | 1~/50/220-240 | 1~/50/220-240 | | 3~/50/380-415 | | | |
| Current - 50Hz | Maximum fuse amps (MFA) | | | A | 16 | 25 | 32 | 16 | | | |

(1) MFA is used to select the circuit breaker and the ground fault circuit interrupter (earth leakage circuit breaker). For more detailed information on each combination, please refer to the electrical data drawing.

*Note: blue cells contain preliminary data

Concealed ceiling unit with medium ESP

Slimmest yet most powerful medium static pressure unit on the market

- › Slimmest unit in class, only 245mm (300mm built-in height) and therefore narrow ceiling voids are no longer a challenge
- › Low operation sound level down to 25dBA
- › Medium external static pressure up to 150Pa facilitates using flexible ducts of varying lengths
- › Possibility to change ESP via wired remote control allows optimisation of the supply air volume



Optimised supply air volume

Automatically selects the most appropriate fan curve to achieve the units' nominal air flow within ±10%

Why?

After installation the real ducting will frequently differ from the initially calculated air flow resistance → the real air flow may be much lower or higher than nominal, leading to a lack of capacity or uncomfortable air temperature

Automatic Airflow Adjustment function will adapt the unit's fan speed to any ducting automatically (10 or more fan curves are available on every model), making installation much faster

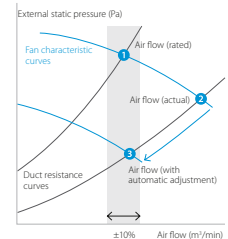

| Efficiency data | | FBA + RXM | | 35A9 + 35N9 | | 50A9 + 50N9 | | 60A9 + 60N9 | | |
|------------------------------------|--------------------------|-----------------------|-----------------|--|---|----------------|------|----------------|-----------|--|
| Cooling capacity | Nom. | kW | | 3.40 | | 5.00 | | 5.70 | | |
| Heating capacity | Nom. | kW | | 4.00 | | 5.50 | | 7.00 | | |
| Space cooling | Energy efficiency class | | | | A++ | | | | A+ | |
| | Capacity | Pdesign | kW | | 3.40 | | 5.00 | | 5.70 | |
| | SEER | | | | 6.23 | | 6.27 | | 5.91 | |
| | ηs,c | | % | | - | | - | | - | |
| Annual energy consumption | | kWh/a | | 191 | | 279 | | 337 | | |
| Space heating (Average climate) | Energy efficiency class | | | | | | A+ | | | |
| | Capacity | Pdesign | kW | | 2.90 | | 4.40 | | 4.60 | |
| | SCOP/A | | | | 4.07 | | 4.06 | | 4.01 | |
| | ηs,h | | % | | - | | - | | - | |
| Annual energy consumption | | kWh/a | | 996 | | 1,517 | | 1,607 | | |
| Indoor unit | | FBA | | 35A9 | | 50A9 | | 60A9 | | |
| Dimensions | Unit | HeightxWidthxDepth | | mm | | 245x700x800 | | 245x1,000x800 | | |
| Weight | Unit | kg | | 28.0 | | | | 35.0 | | |
| Air filter | Type | Resin net | | | | | | | | |
| Fan | Air flow rate | Cooling | Low/Medium/High | m ³ /min | | 10.5/12.5/15.0 | | 12.5/15.0/18.0 | | |
| | | Heating | Low/Medium/High | m ³ /min | | 10.5/12.5/15.0 | | 12.5/15.0/18.0 | | |
| | External static pressure | Nom./High | Pa | | 30/150 | | | | | |
| Sound power level | Cooling | dBA | | 60.0 | | | | 56.0 | | |
| Sound pressure level | Cooling | Low/High | dBA | | 29.0/35.0 | | | | 25.0/30.0 | |
| | Heating | Low/High | dBA | | 29.0/37.0 | | | | 25.0/31.0 | |
| Control systems | Infrared remote control | | | | BRC4C65 / BRC4C66 | | | | | |
| | Wired remote control | | | | BRC1H519W7/S7/K7 / BRC1E53A/B/C / BRC1D52 | | | | | |
| Power supply | Phase/Frequency/Voltage | | Hz/V | | 1~/50/60/220-240/220 | | | | | |
| Outdoor unit | | RXM | | 35N9 | | 50N9 | | 60N9 | | |
| Dimensions | Unit | HeightxWidthxDepth | | mm | | 550x765x285 | | 734x870x373 | | |
| Weight | Unit | kg | | 32 | | 50 | | 63 | | |
| Sound power level | Cooling | dBA | | 61 | | 62 | | 63 | | |
| | Heating | dBA | | 61 | | 62 | | 63 | | |
| Sound pressure level | Cooling | Nom. | dBA | | 49 | | 48 | | | |
| | Heating | Nom. | dBA | | 49 | | | | | |
| Operation range | Cooling | Ambient | Min.~Max. | °CDB | | -10~50 | | | | |
| | Heating | Ambient | Min.~Max. | °CWB | | -20~24 | | | | |
| Refrigerant | Type | R-32 | | | | | | | | |
| | GWP | 675 | | | | | | | | |
| Piping connections | Charge | kg/CO ₂ Eq | | 0.76/0.52 | | 1.15/0.78 | | | | |
| | Liquid | OD | mm | | 635 | | 64 | | | |
| | Gas | OD | mm | | 9.50 | | 12.7 | | | |
| | Piping length | OU - IU | Max. | m | | 20 | | 30 | | |
| | System | Chargeless | m | | 10 | | - | | | |
| Additional refrigerant charge | | kg/m | | 0.02 (for piping length exceeding 10m) | | | | | | |
| Level difference | IU - OU | Max. | | m | | 15 | | 20 | | |
| Power supply | Phase/Frequency/Voltage | | Hz/V | | 1~/50/220-240 | | | | | |
| Current - 50Hz | Maximum fuse amps (MFA) | | A | | - | | | | | |